

Planning Board
Town of Nottingham
139 Stage Road
Nottingham, NH 03861

February 13, 2020

Dear Planning Board Members:

This letter is to inform the Town of Nottingham that Eversource is planning to trim and remove trees and brush adjacent to and beneath some of its power lines within the town. This work is necessary to insure the safe distribution of power and to improve the reliability of electric service for our customers

According to Eversource records Stevens Hill Road, Case Road, Gile Road, Ledge Farm Road, Mitchell Road, and Poor Farm Road have been designated as scenic roads by the Town. Please consider this letter a request from Eversource for a public hearing for the trimming and removal of trees and brush along these roads within the proposed work area pursuant to RSA 231:158. Please inform this office of the time and place of said meeting so that we may have a representative present. A map highlighting the area to be trimmed is enclosed.

Eversource specifications call for the removal of brush and limbs which are located within eight feet to the side, ten feet below or fifteen above conductors. Trees which present a threat to Eversource lines or other equipment because of decay or other defect will be removed on a case by case basis. A list of "risk" trees identified for removal by Eversource has been included. All trees are marked with a blue and white checkered ribbon.

All work will be performed in accordance with accepted arboricultural standards. Eversource has contracted with Asplundh Tree Expert to perform the actual clearing of trees. Eversource requires that our clearing contractor contact each landowner where trees are to be trimmed or removed prior to commencement of work on that property. Individual concerns will be addressed at this time.

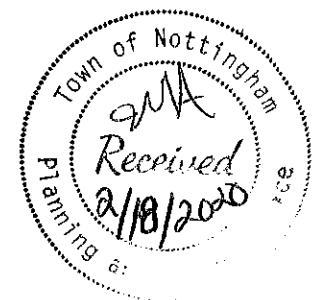

1. The first part of the document discusses the importance of maintaining accurate records of all transactions and activities. It emphasizes that this is crucial for ensuring transparency and accountability in the organization's operations.

2. The second part of the document outlines the various methods and tools used to collect and analyze data. It highlights the need for consistent and reliable data collection processes to support informed decision-making.

3. The third part of the document focuses on the role of technology in data management and analysis. It discusses how modern software solutions can streamline data collection, storage, and reporting, thereby improving efficiency and accuracy.

4. The fourth part of the document addresses the challenges associated with data management, such as data quality, security, and privacy. It provides strategies to mitigate these risks and ensure that data is used responsibly and ethically.

5. The fifth part of the document discusses the importance of data governance and the establishment of clear policies and procedures. It emphasizes the need for a strong data governance framework to ensure that data is managed effectively and in compliance with relevant regulations.

6. The sixth part of the document explores the role of data in strategic planning and performance management. It highlights how data-driven insights can help organizations identify opportunities, optimize resources, and achieve their long-term goals.

7. The seventh part of the document discusses the importance of data literacy and training for all employees. It emphasizes that having a data-driven culture is essential for organizations to thrive in a competitive market.

8. The eighth part of the document addresses the future of data management and analysis. It discusses emerging trends such as artificial intelligence, machine learning, and big data, and how they will shape the way organizations use data.

9. The ninth part of the document provides a summary of the key points discussed in the document. It reiterates the importance of data in driving organizational success and the need for a comprehensive data management strategy.

10. The tenth part of the document concludes with a call to action, encouraging organizations to embrace data-driven decision-making and to continuously improve their data management practices.

All brush and limbs cut on roadside locations will be chipped. In wooded, undeveloped locations, these chips may be dispersed into the woods taking care not to allow chips to accumulate in piles or in ditches. Near developed land, the chips will be blown into a truck and disposed of offsite. The chips make good mulch and are often given to nearby property owners for landscaping purposes. If a central dumping location could be arranged, Eversource would be happy to make any unclaimed chips available to the Town at no cost. Brush and limbs cut on inaccessible lines will be stacked to the side of the right-of way and cut low to the ground. All wood will be left on site unless otherwise directed by the landowner.

Work is scheduled to begin in the near future.

If you have any questions or comments, please feel free to contact me at the above address, by telephone at 603-634-3469 or by e-mail at Robert.Berner@Eversource.com.

Thank you for your concern and assistance.

Respectfully,

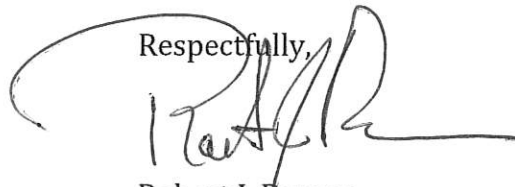

Robert J. Berner
Eastern Region Arborist
Eversource

1. The first part of the document discusses the importance of maintaining accurate records of all transactions and activities. It emphasizes the need for transparency and accountability in financial reporting.

2. The second part of the document outlines the various methods and techniques used to collect and analyze data. It covers both qualitative and quantitative research approaches, highlighting the strengths and limitations of each.

3. The third part of the document focuses on the interpretation and presentation of results. It discusses how to effectively communicate findings to different audiences and how to draw meaningful conclusions from the data.

4. The final part of the document provides a summary of the key points and offers recommendations for future research. It encourages ongoing learning and improvement in the field of data analysis and reporting.

Towns of NOTTINGHAM SCENE

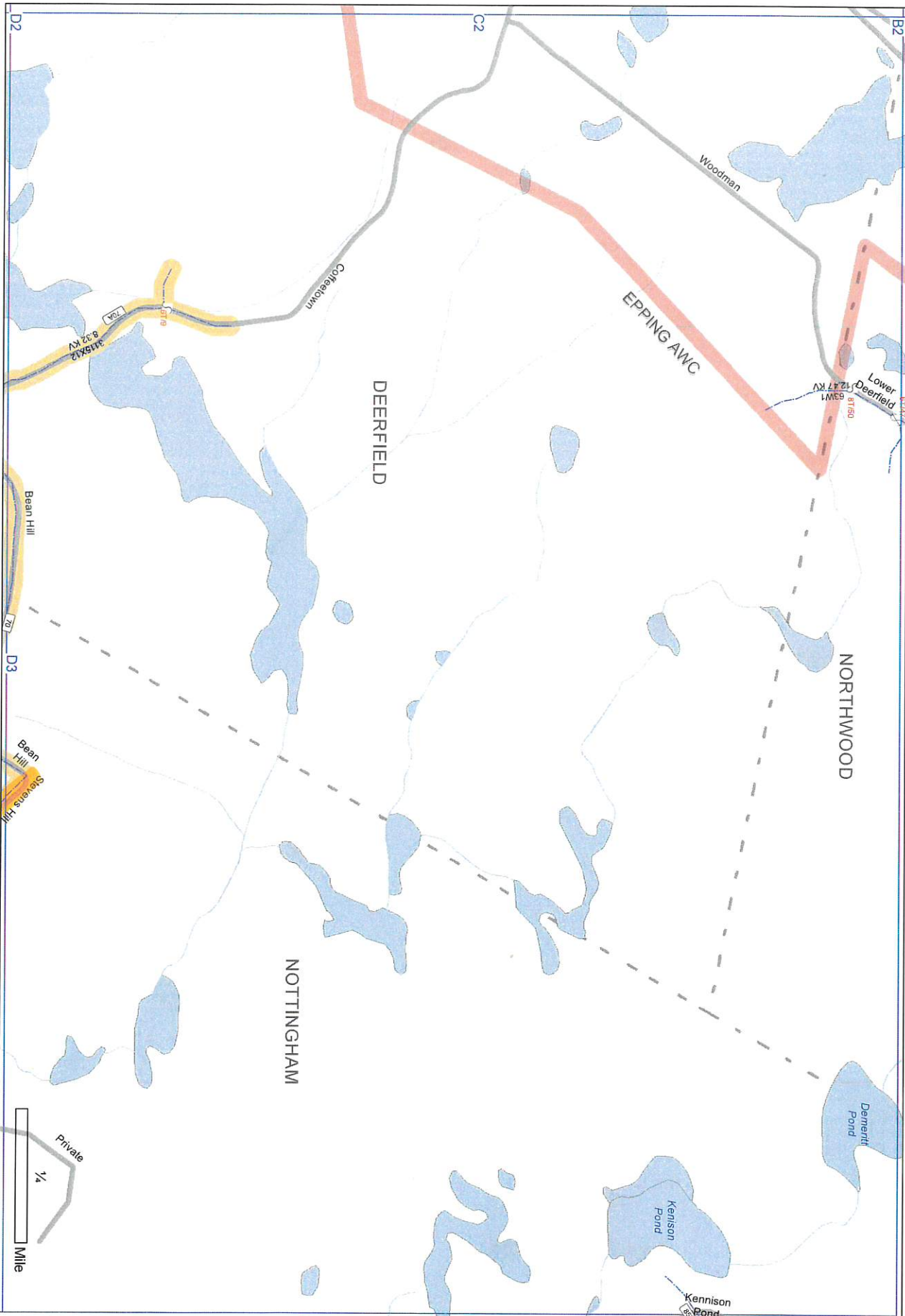

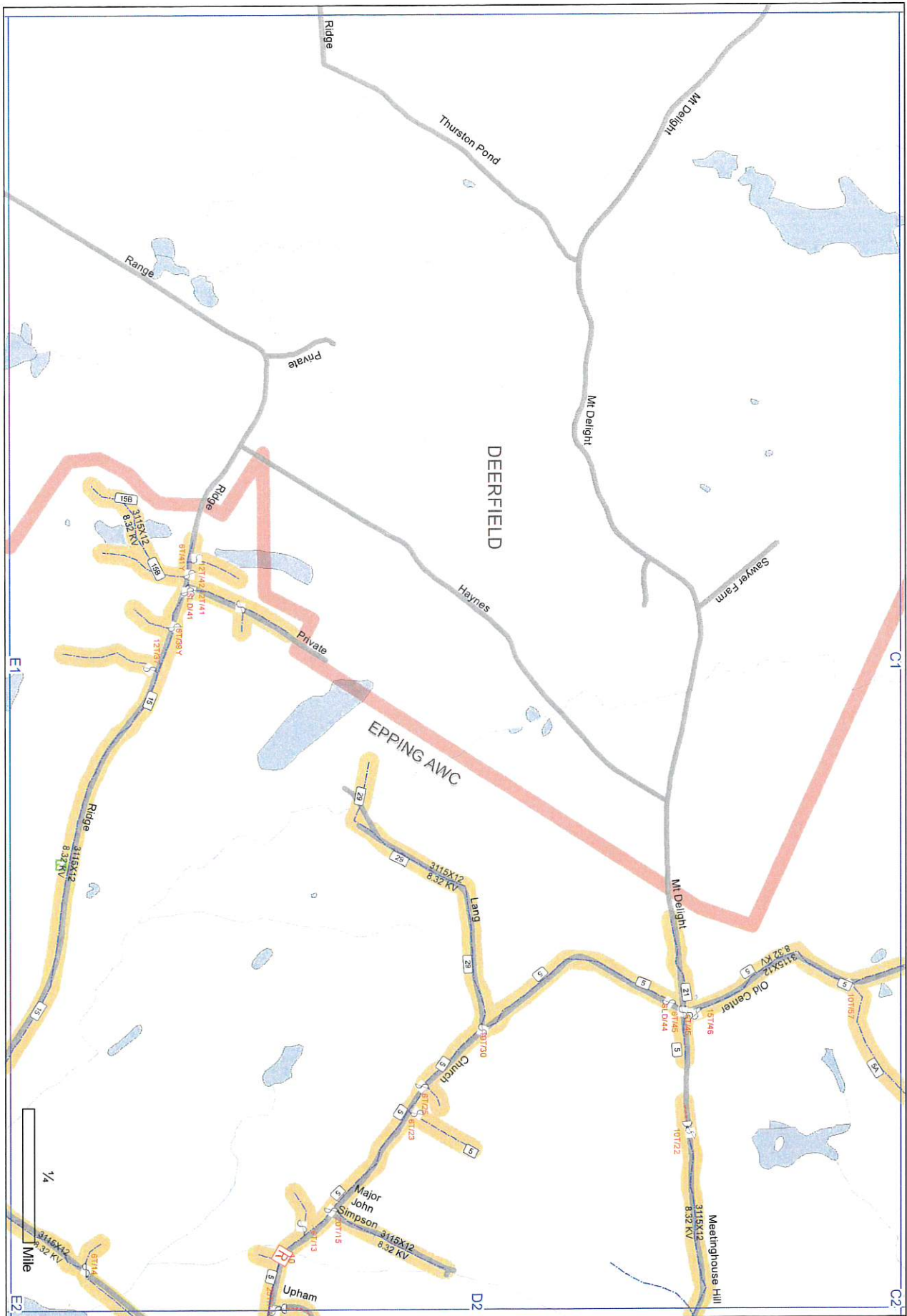

Eversource

- F Fire
- N Nursing Home
- P Police
- H Hospital

3115X12

S/S: 3115X12_14 TAP

Date: 1/3/2020

Feedback: Ronald.Rioux@eversource.com

CEII

Total Customers: 1,943

Grid: D1

Page 8 of 19



D1

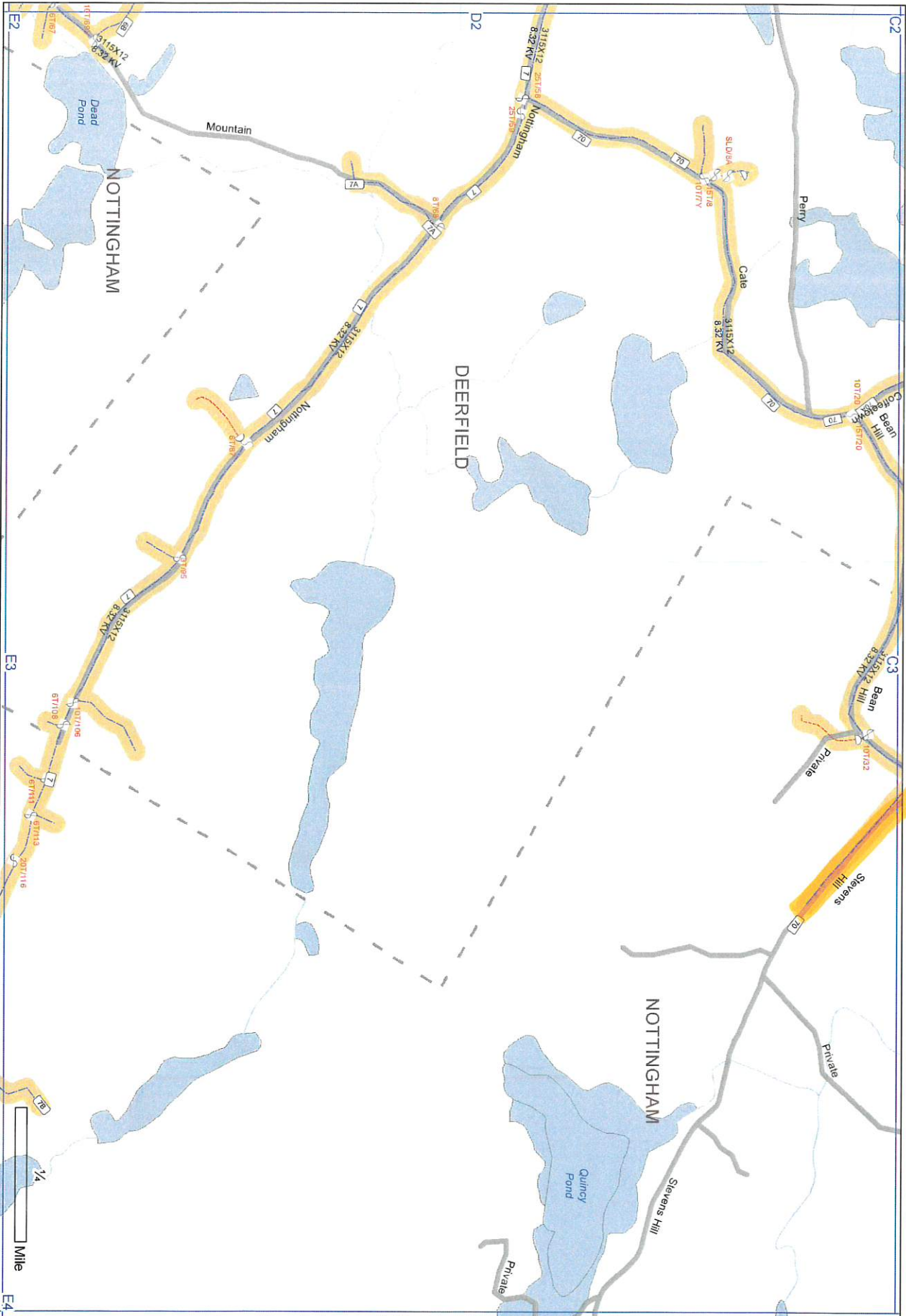

Eversource

- F Fire
- N Nursing Home
- P Police
- H Hospital

3115X12

S/S: 3115X12_14 TAP

Date: 1/3/2020

Feedback: Ronald.Rioux@eversource.com

CEII

Total Customers: 1,943

Grid: D3

Page 10 of 19



D3

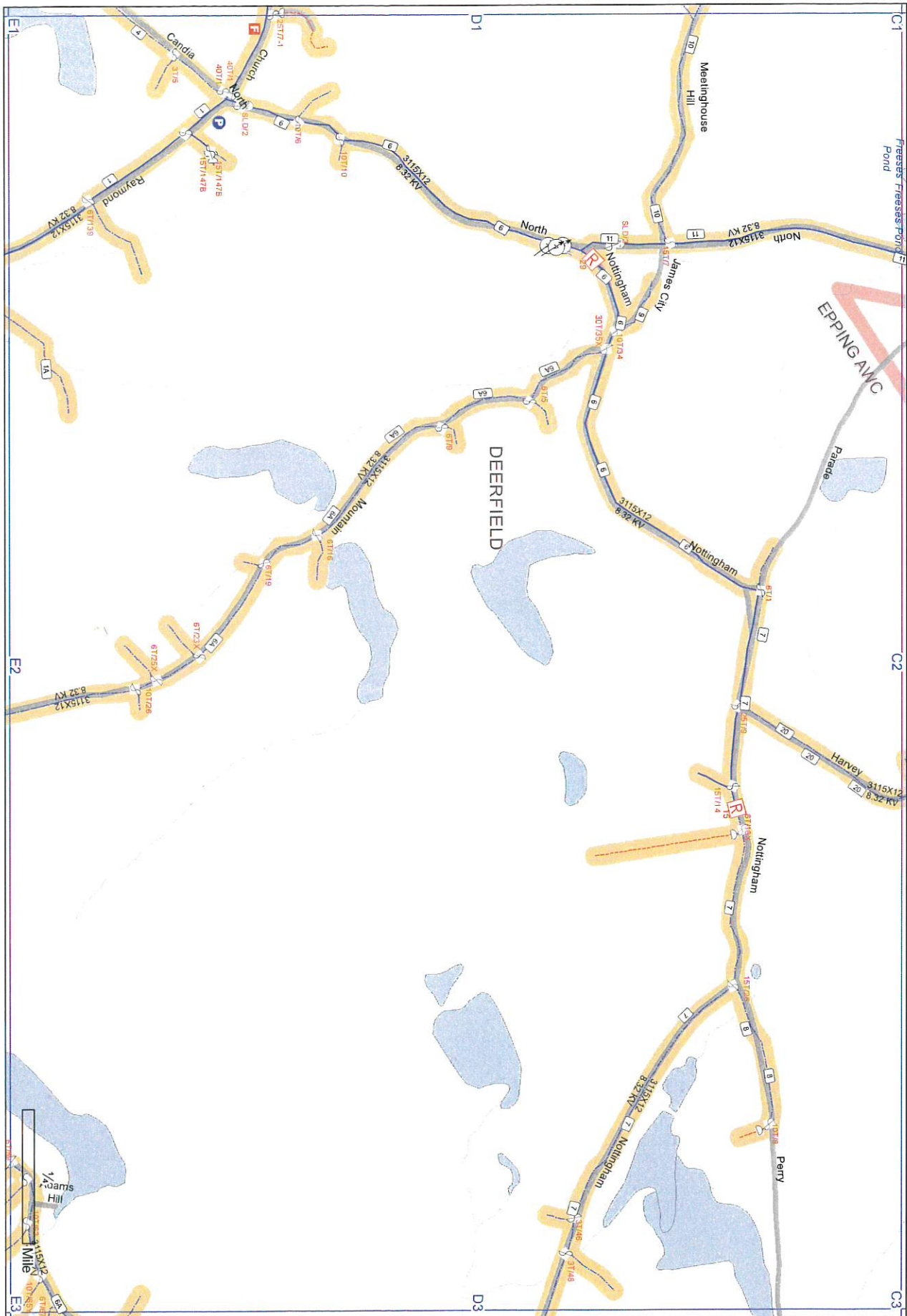

Eversource

- F Fire
- N Nursing Home
- P Police
- H Hospital

3115X12

S/S: 3115X12_14 TAP

Date: 1/3/2020

Feedback: Ronald.Rioux@eversource.com

CEII

Total Customers: 1,943

Grid: D2

Page 9 of 19



D2

1
= Town of NOTTINGHAM Service
CASE, MITCHELL

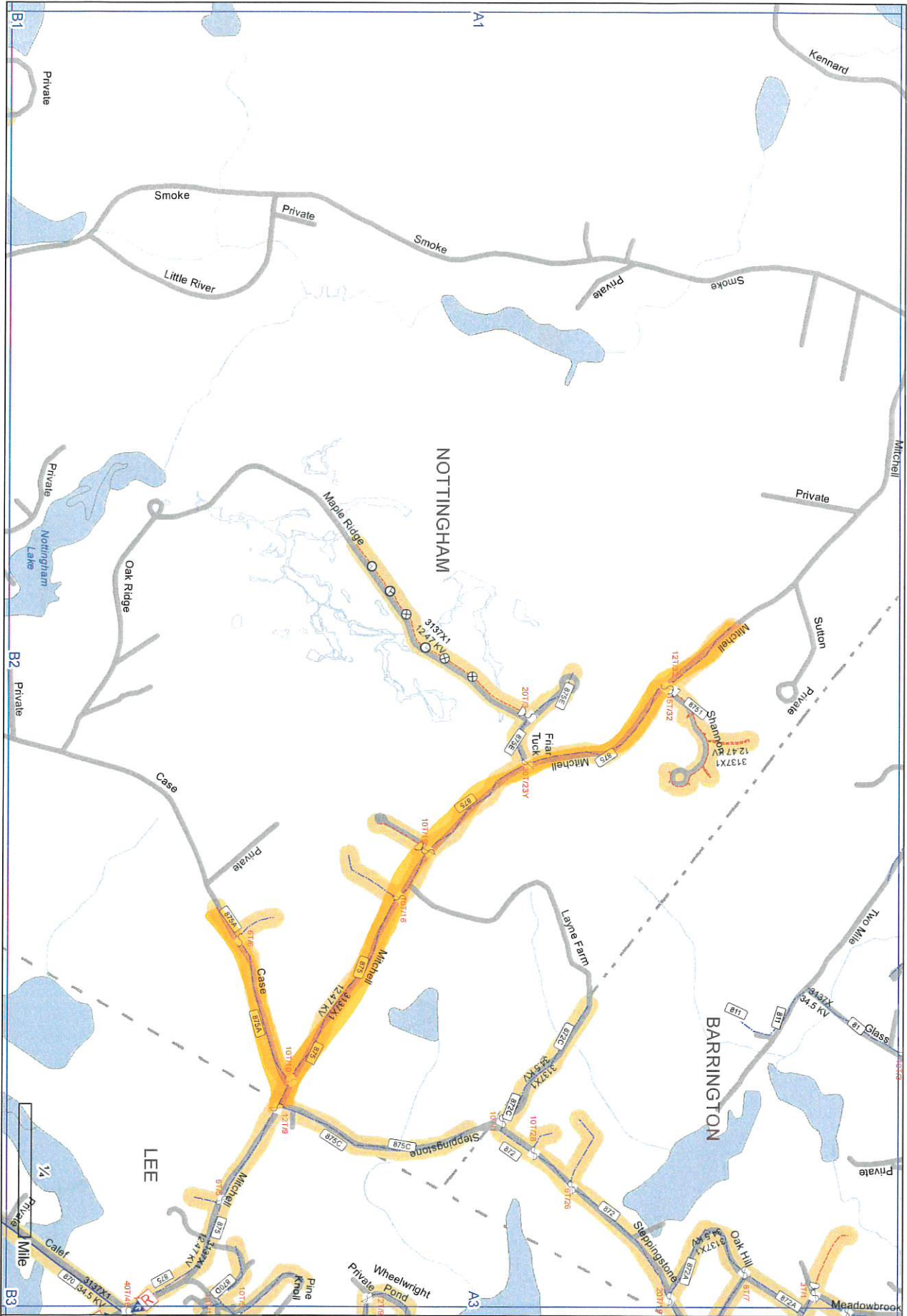

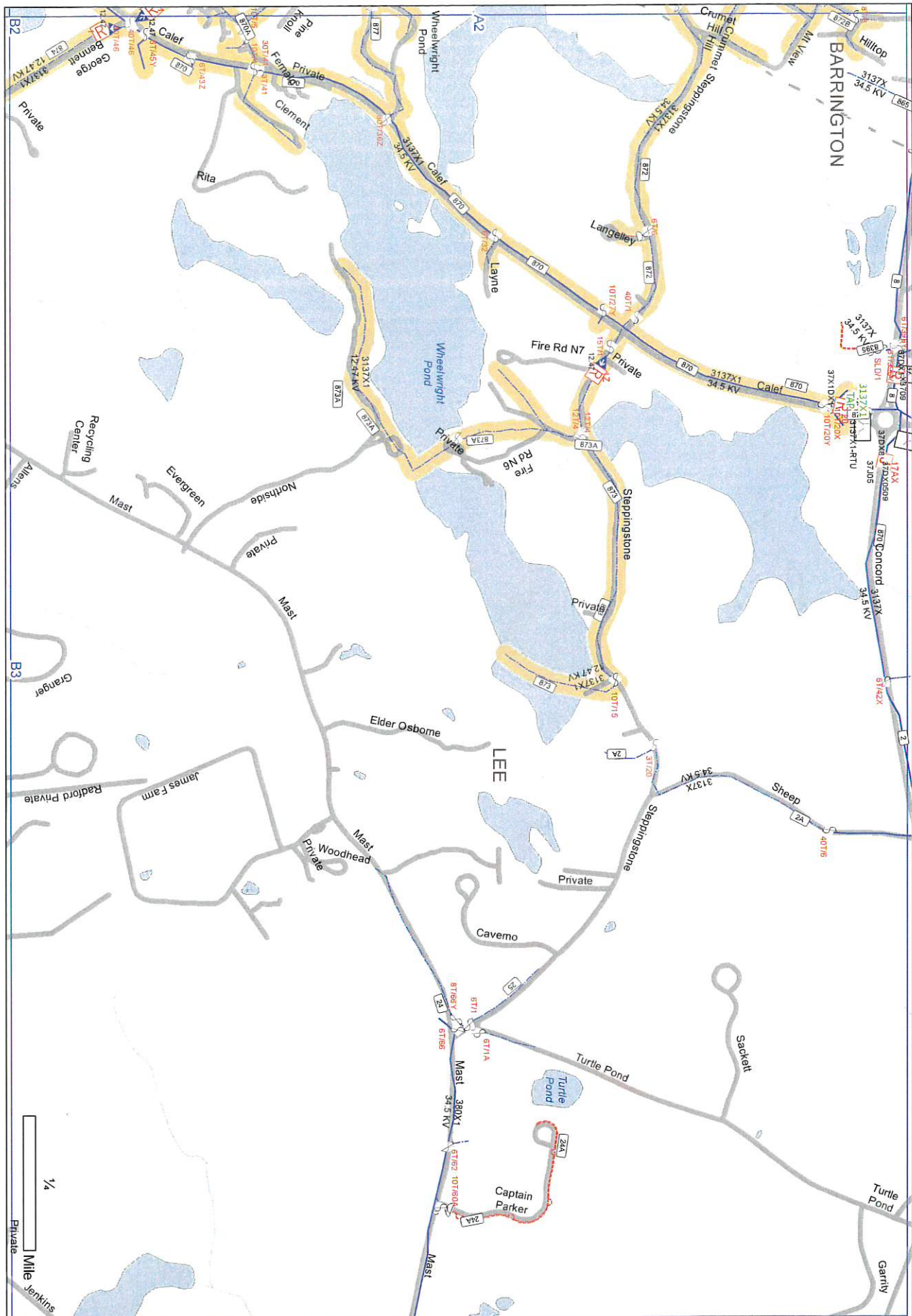

Eversource

- F Fire
- N Nursing Home
- P Police
- H Hospital

3137X1

S/S: 3137X1 TAP

Date: 1/3/2020

Feedback: Ronald.Rioux@eversource.com

CEII

Total Customers: 1,686

Grid: A3

Page 4 of 10



A3

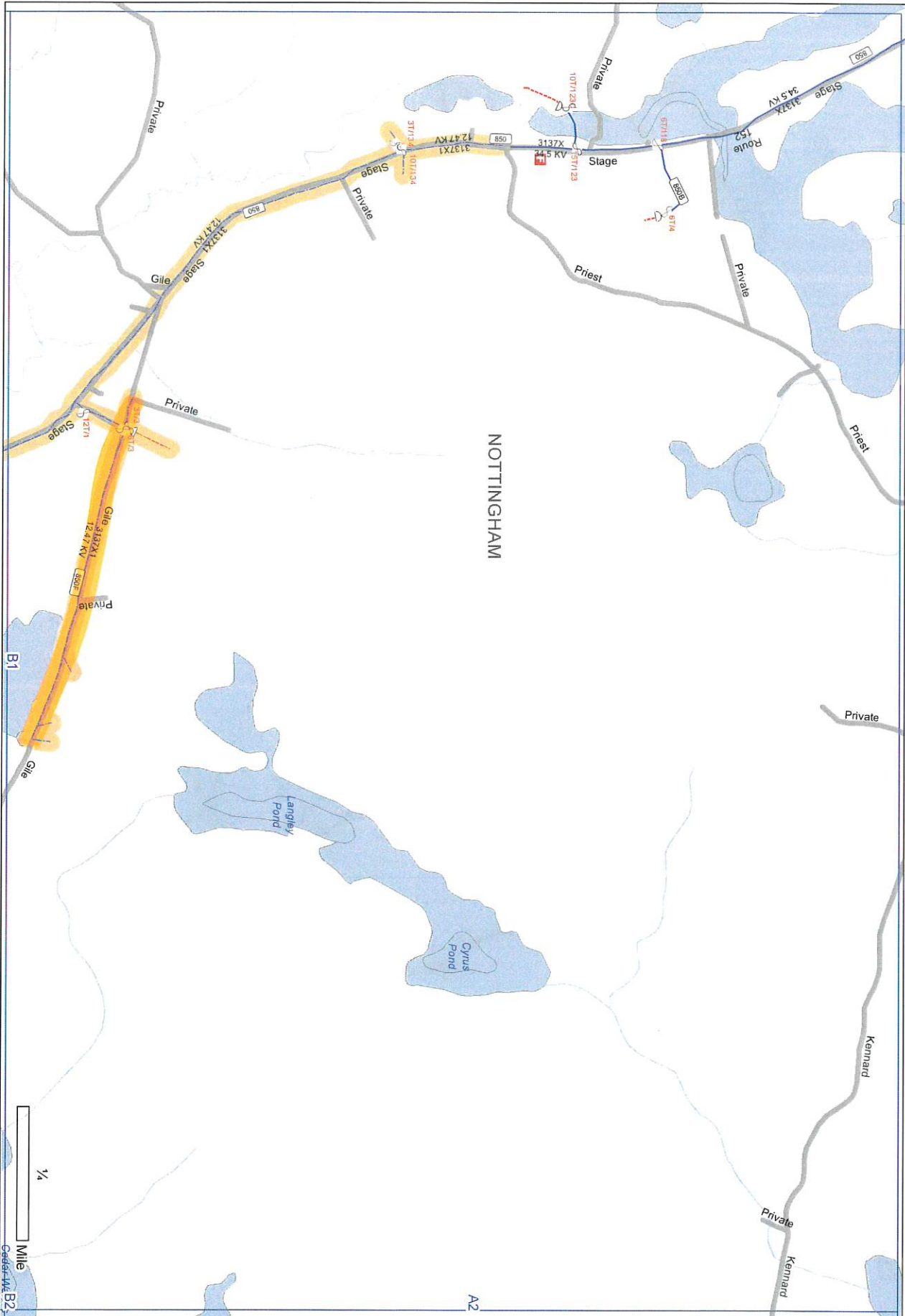

Eversource

- F Fire
- N Nursing Home
- P Police
- H Hospital

3137X1

S/S: 3137X1 TAP

Date: 1/3/2020

Feedback: Ronald.Rioux@eversource.com

CEII

Total Customers: 1,686

Grid: A1

Page 2 of 10



A1

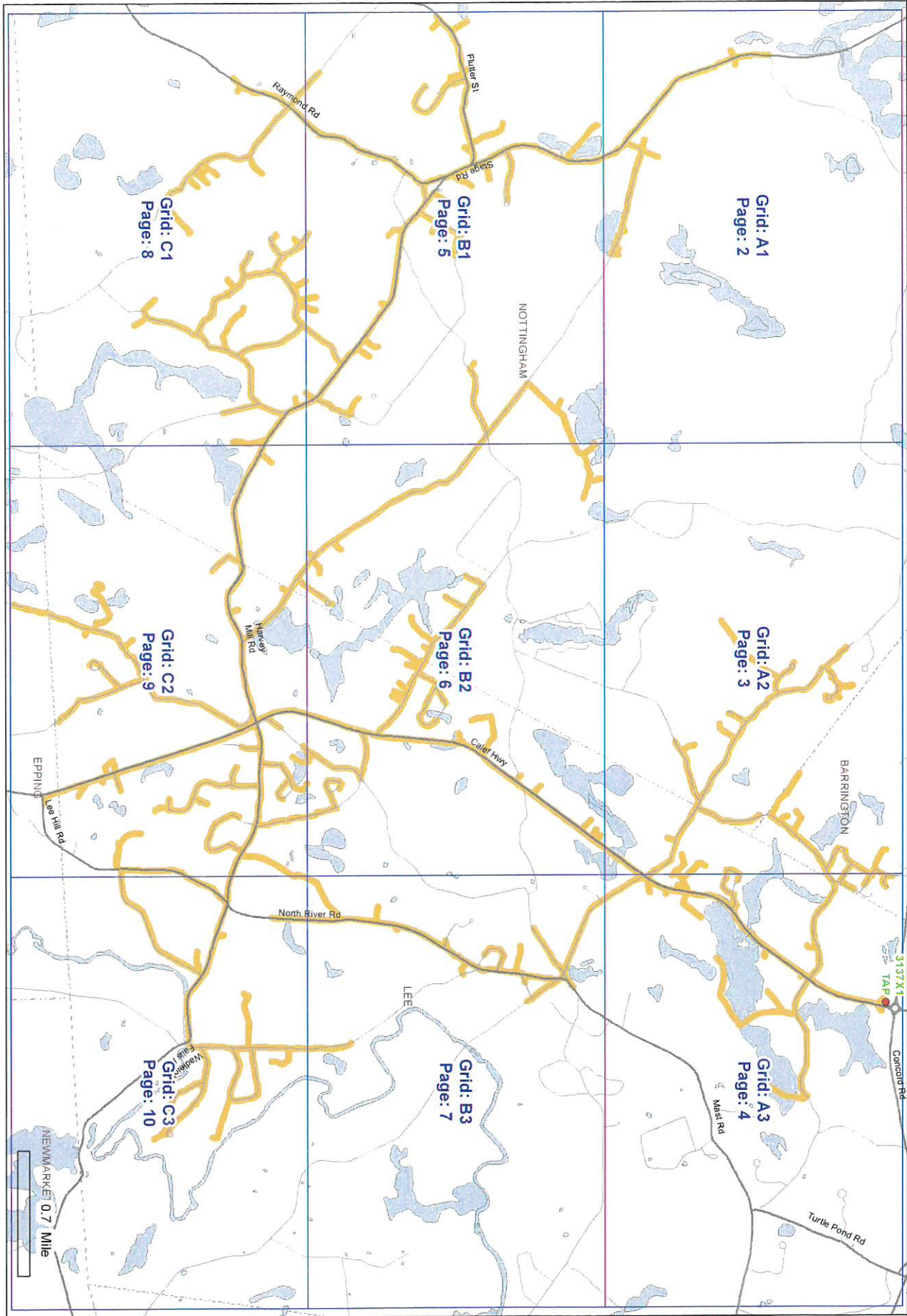

NOTTINGHAM - Gile

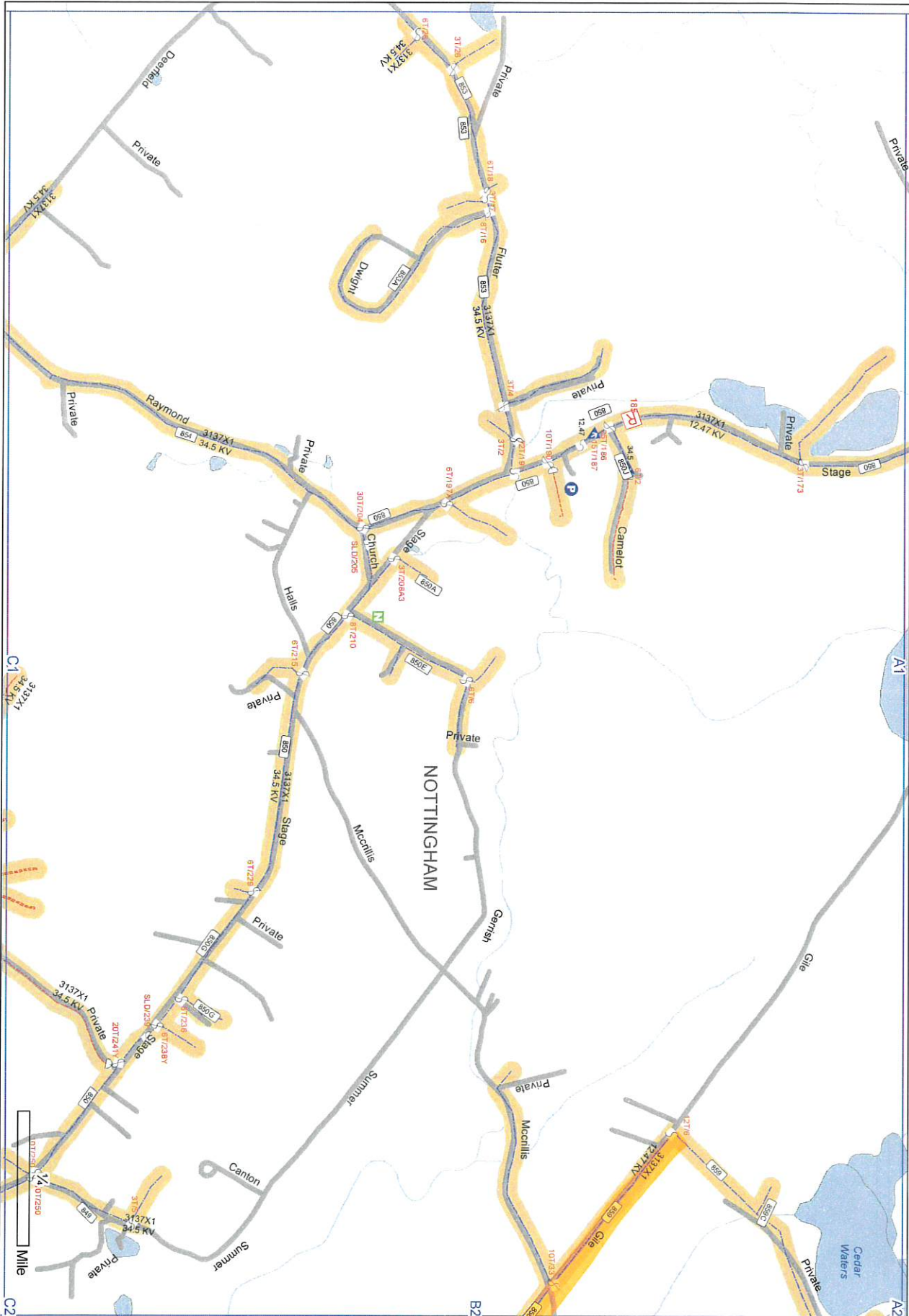

Eversource

- Fire
- Nursing Home
- Police
- Hospital

3137X1

S/S: 3137X1 TAP

Date: 1/3/2020

Feedback: Ronald.Rioux@eversource.com

CEII

Total Customers: 1,686

Grid: B1

Page 5 of 10



B1

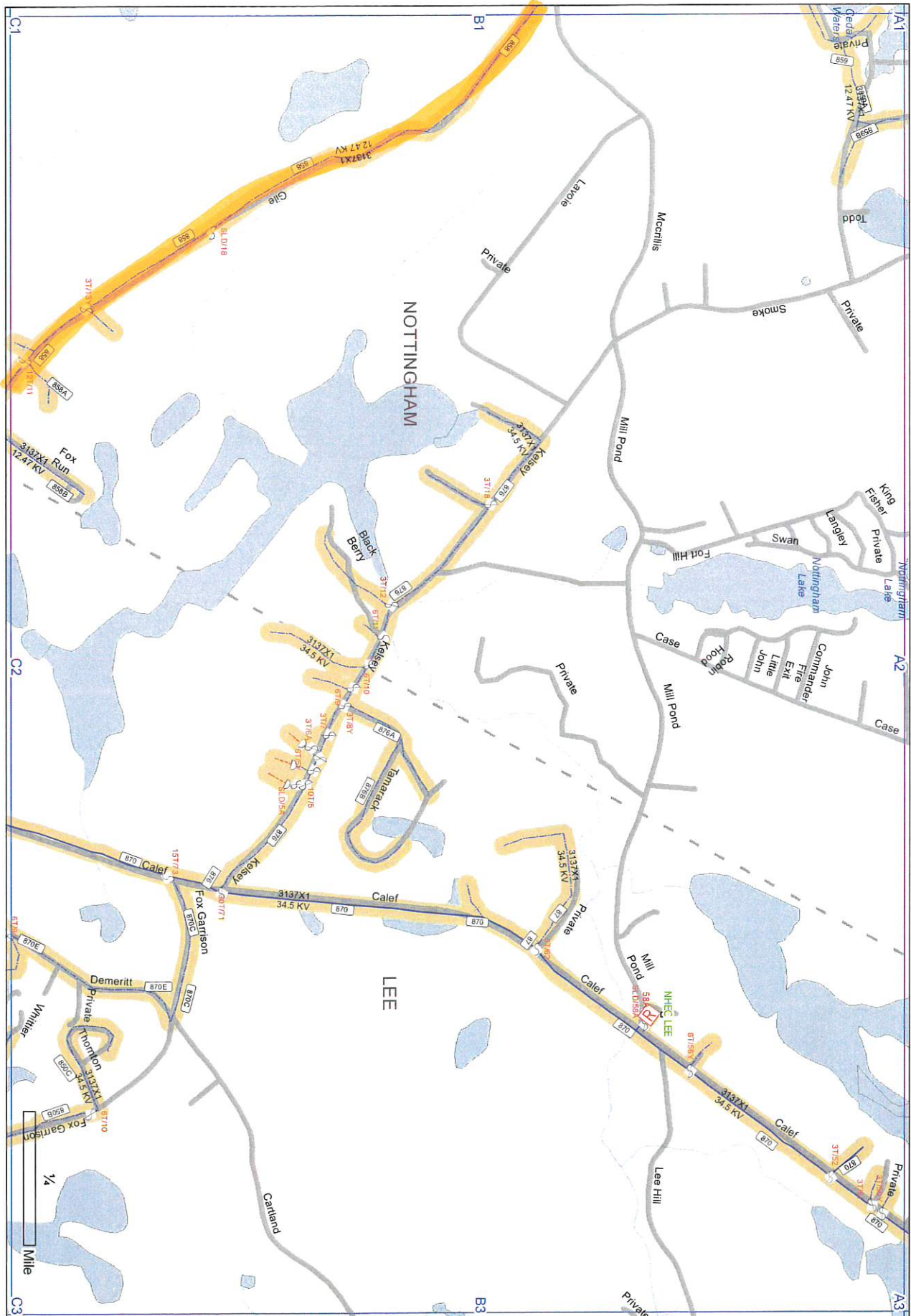

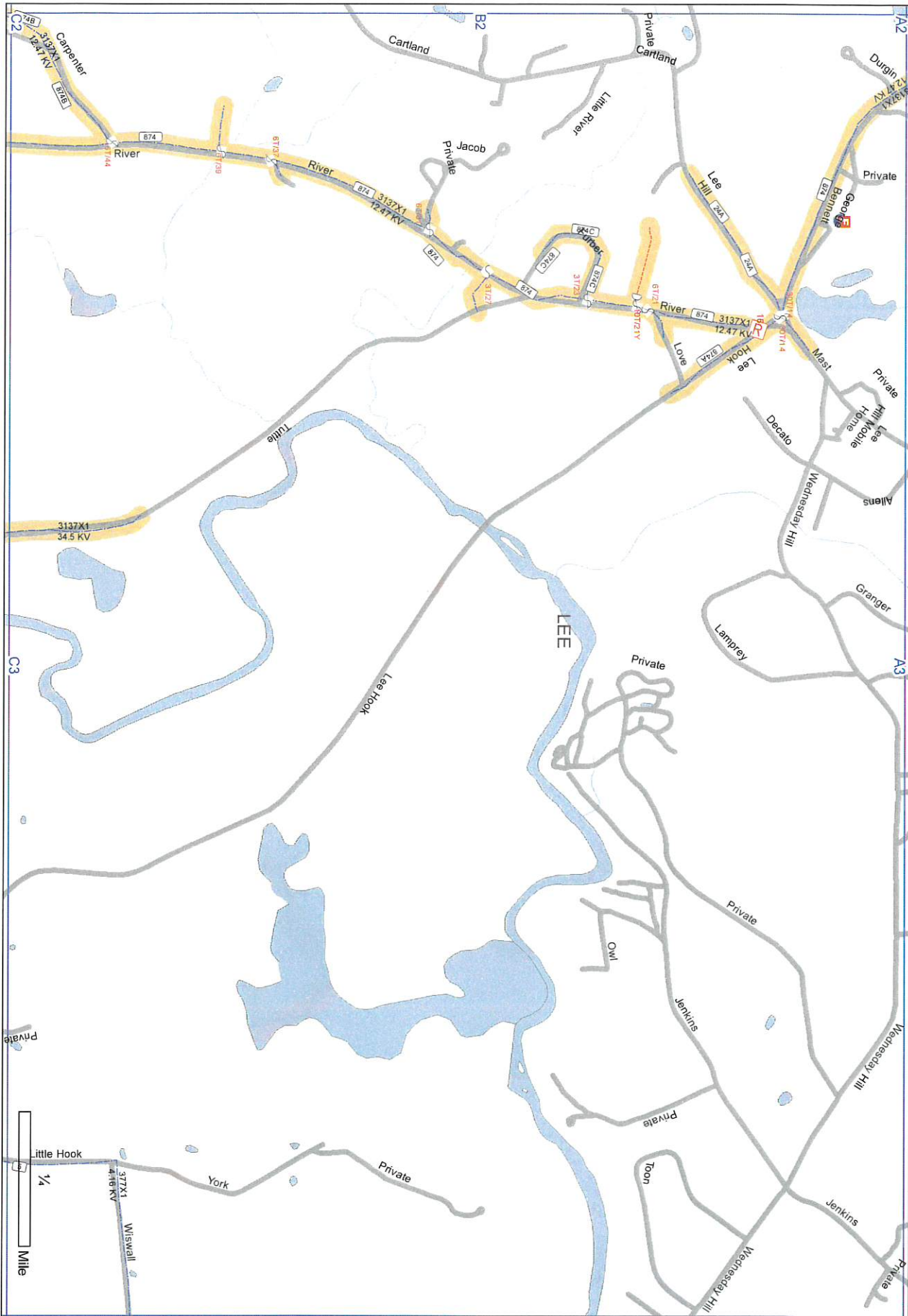

Eversource

- F Fire
- N Nursing Home
- P Police
- H Hospital

3137X1

S/S: 3137X1 TAP

Date: 1/3/2020

Feedback: Ronald.Rioux@eversource.com

CEI

Total Customers: 1,686

Grid: B3

Page 7 of 10



B3

NOTTINGHAM - LEDGE FARM, POOR FARM

