

Planning Board
Town of Nottingham
139 Stage Road
Nottingham, NH 03861

February 13, 2020

Dear Planning Board Members:

This letter is to inform the Town of Nottingham that Eversource is planning to trim and remove trees and brush adjacent to and beneath some of its power lines within the town. This work is necessary to insure the safe distribution of power and to improve the reliability of electric service for our customers

According to Eversource records Stevens Hill Road, Case Road, Gile Road, Ledge Farm Road, Mitchell Road, and Poor Farm Road have been designated as scenic roads by the Town. Please consider this letter a request from Eversource for a public hearing for the trimming and removal of trees and brush along these roads within the proposed work area pursuant to RSA 231:158. Please inform this office of the time and place of said meeting so that we may have a representative present. A map highlighting the area to be trimmed is enclosed.

Eversource specifications call for the removal of brush and limbs which are located within eight feet to the side, ten feet below or fifteen above conductors. Trees which present a threat to Eversource lines or other equipment because of decay or other defect will be removed on a case by case basis. A list of "risk" trees identified for removal by Eversource has been included. All trees are marked with a blue and white checkered ribbon.

All work will be performed in accordance with accepted arboricultural standards. Eversource has contracted with Asplundh Tree Expert to perform the actual clearing of trees. Eversource requires that our clearing contractor contact each landowner where trees are to be trimmed or removed prior to commencement of work on that property. Individual concerns will be addressed at this time.



All brush and limbs cut on roadside locations will be chipped. In wooded, undeveloped locations, these chips may be dispersed into the woods taking care not to allow chips to accumulate in piles or in ditches. Near developed land, the chips will be blown into a truck and disposed of offsite. The chips make good mulch and are often given to nearby property owners for landscaping purposes. If a central dumping location could be arranged, Eversource would be happy to make any unclaimed chips available to the Town at no cost. Brush and limbs cut on inaccessible lines will be stacked to the side of the right-of way and cut low to the ground. All wood will be left on site unless otherwise directed by the landowner.

Work is scheduled to begin in the near future.

If you have any questions or comments, please feel free to contact me at the above address, by telephone at 603-634-3469 or by e-mail at Robert.Berner@Eversource.com.

Thank you for your concern and assistance.

Respectfully,

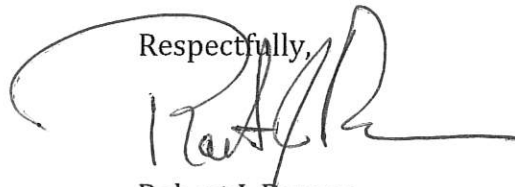
A handwritten signature in black ink, appearing to read 'Robert Berner', written over the word 'Respectfully,'.

Robert J. Berner
Eastern Region Arborist
Eversource

Towns of NOTTINGHAM SCENE

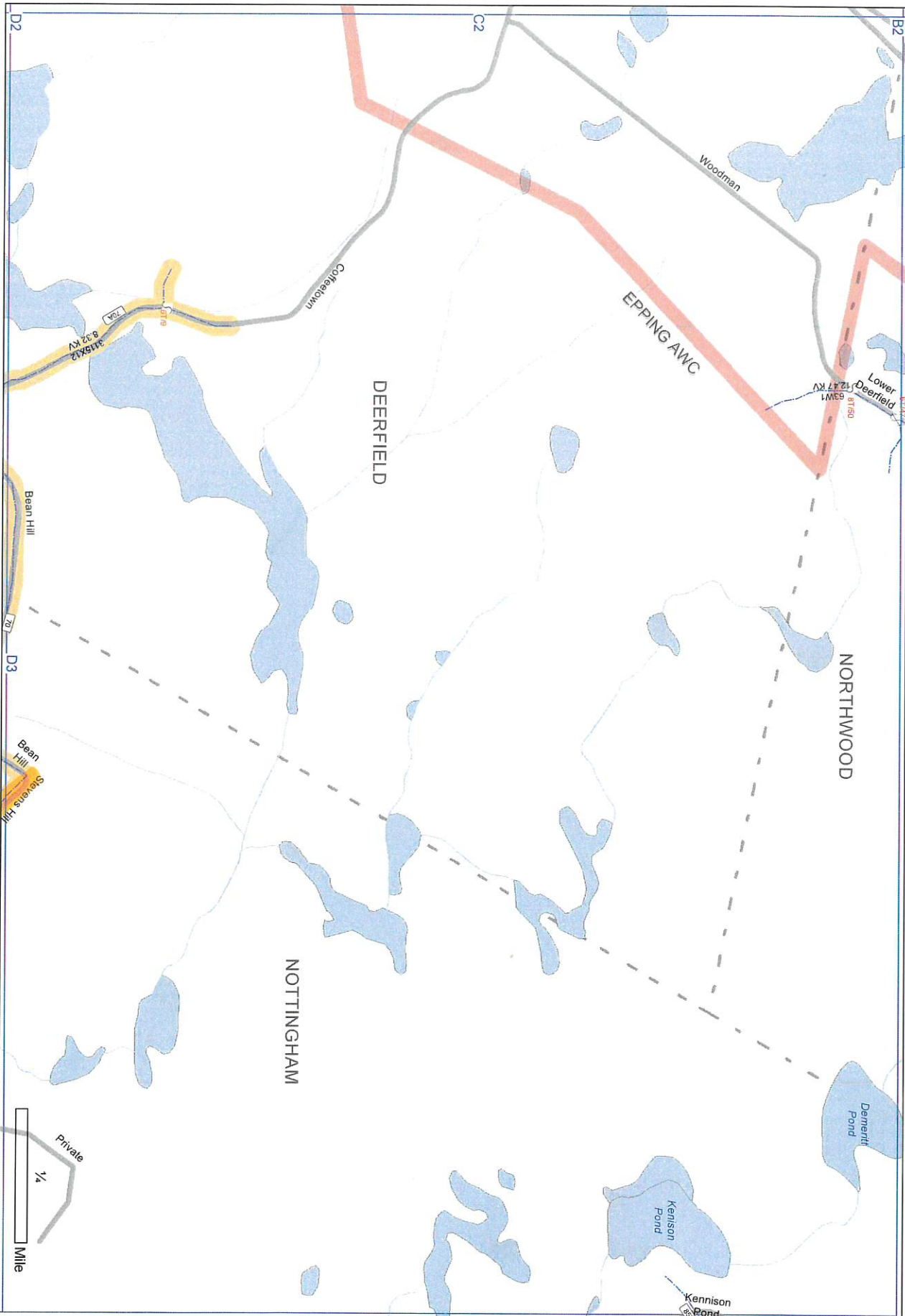

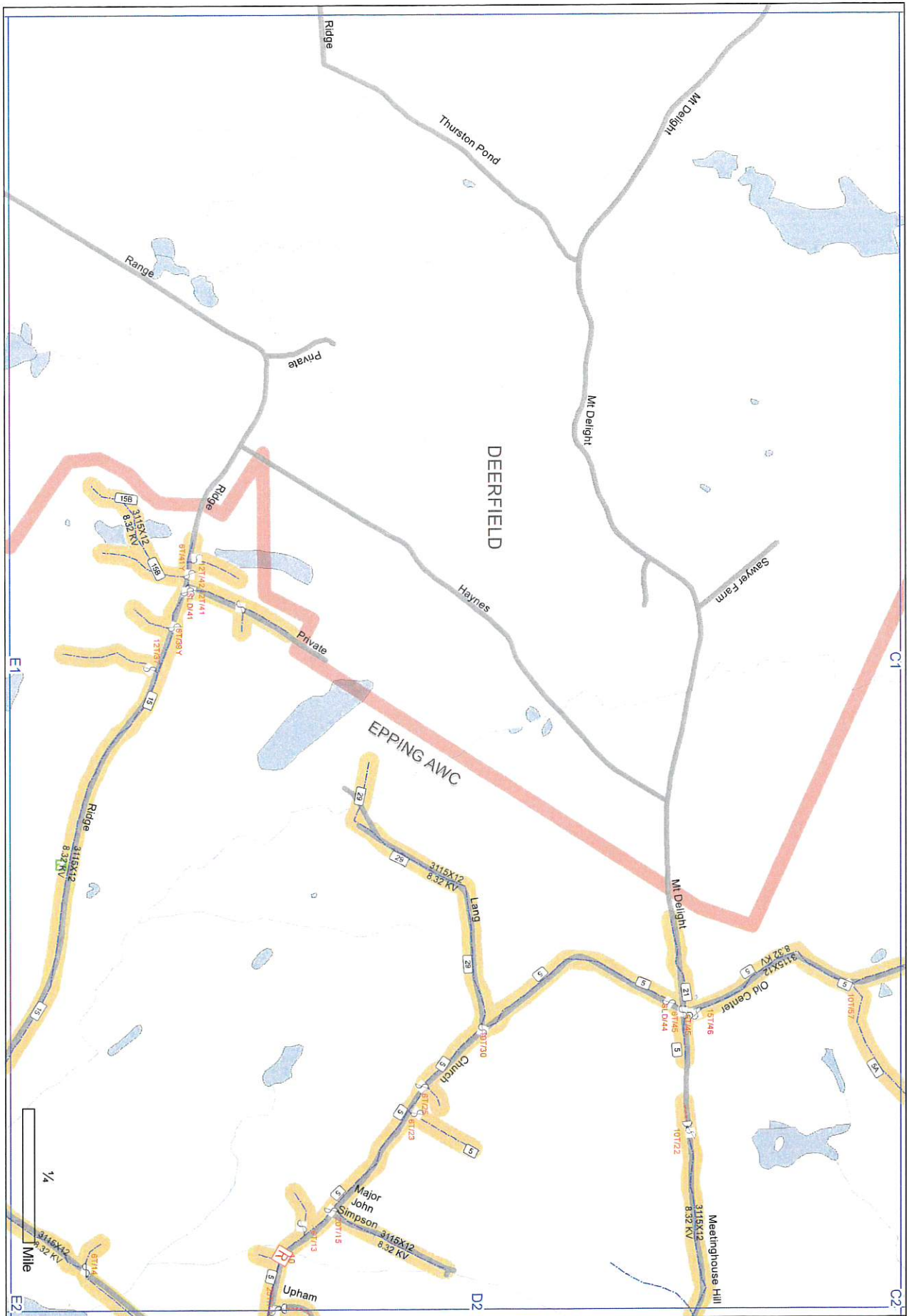

Eversource

- F Fire
- N Nursing Home
- P Police
- H Hospital

3115X12

S/S: 3115X12_14 TAP

Date: 1/3/2020

Feedback: Ronald.Rioux@eversource.com

CEII

Total Customers: 1,943

Grid: D1

Page 8 of 19



D1

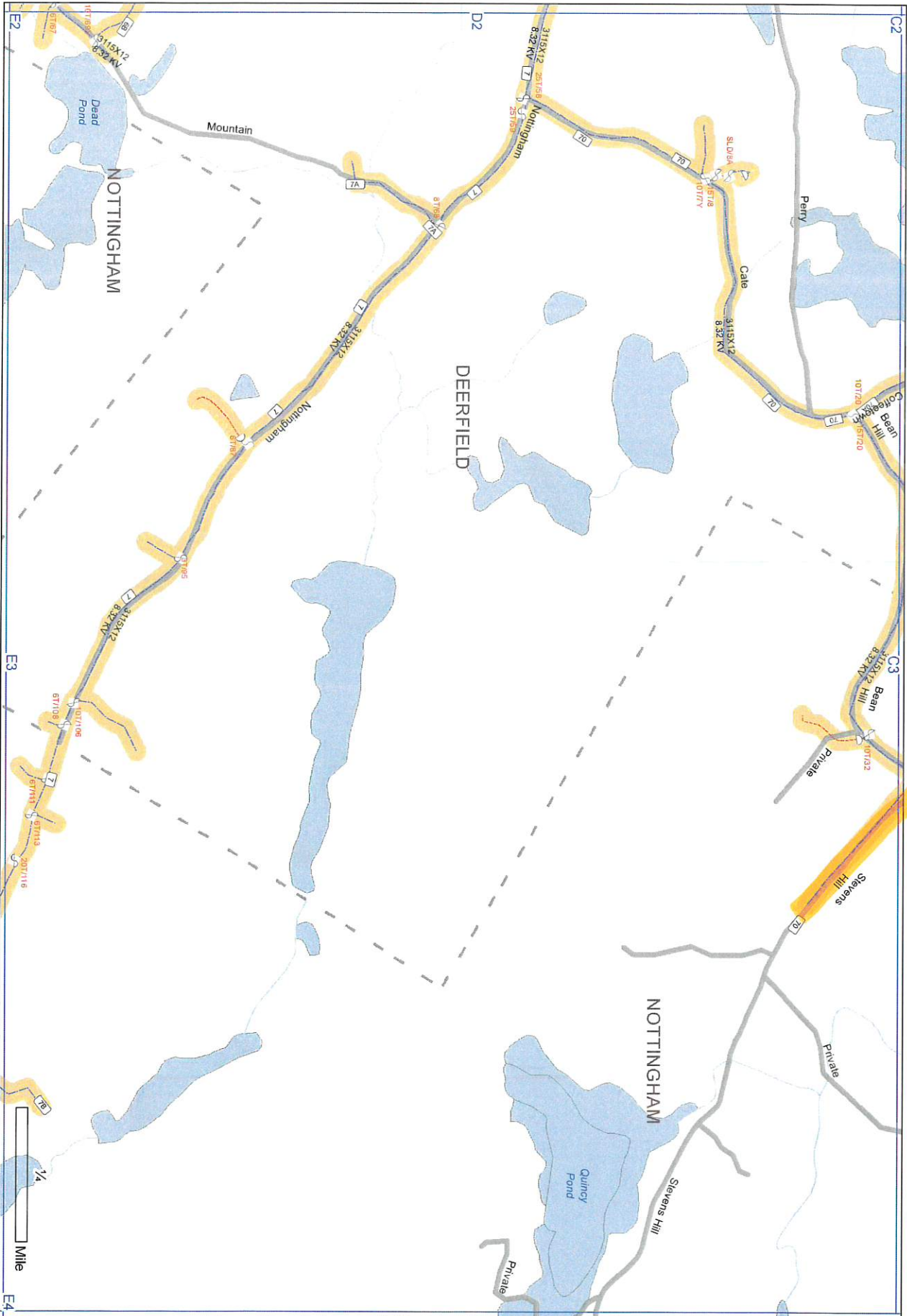

Eversource

- F Fire
- N Nursing Home
- P Police
- H Hospital

3115X12

S/S: 3115X12_14 TAP

Date: 1/3/2020

Feedback: Ronald.Rioux@eversource.com

CEII

Total Customers: 1,943

Grid: D3

Page 10 of 19



D3

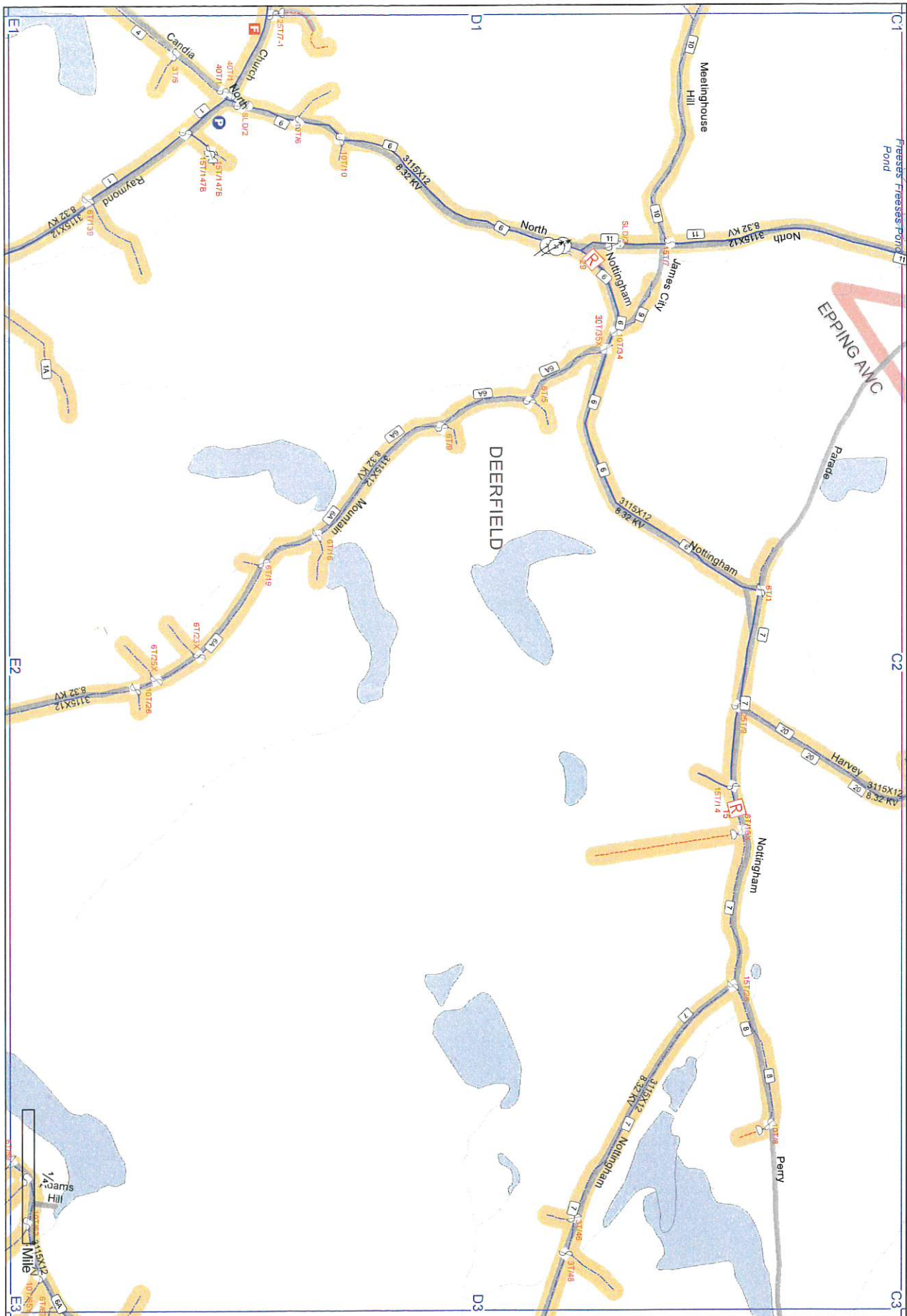

Eversource

- F Fire
- N Nursing Home
- P Police
- H Hospital

3115X12

S/S: 3115X12_14 TAP

Date: 1/3/2020

Feedback: Ronald.Rioux@eversource.com

CEII

Total Customers: 1,943

Grid: D2

Page 9 of 19



D2

1
= Town of NOTTINGHAM Service
CASE, MITCHELL

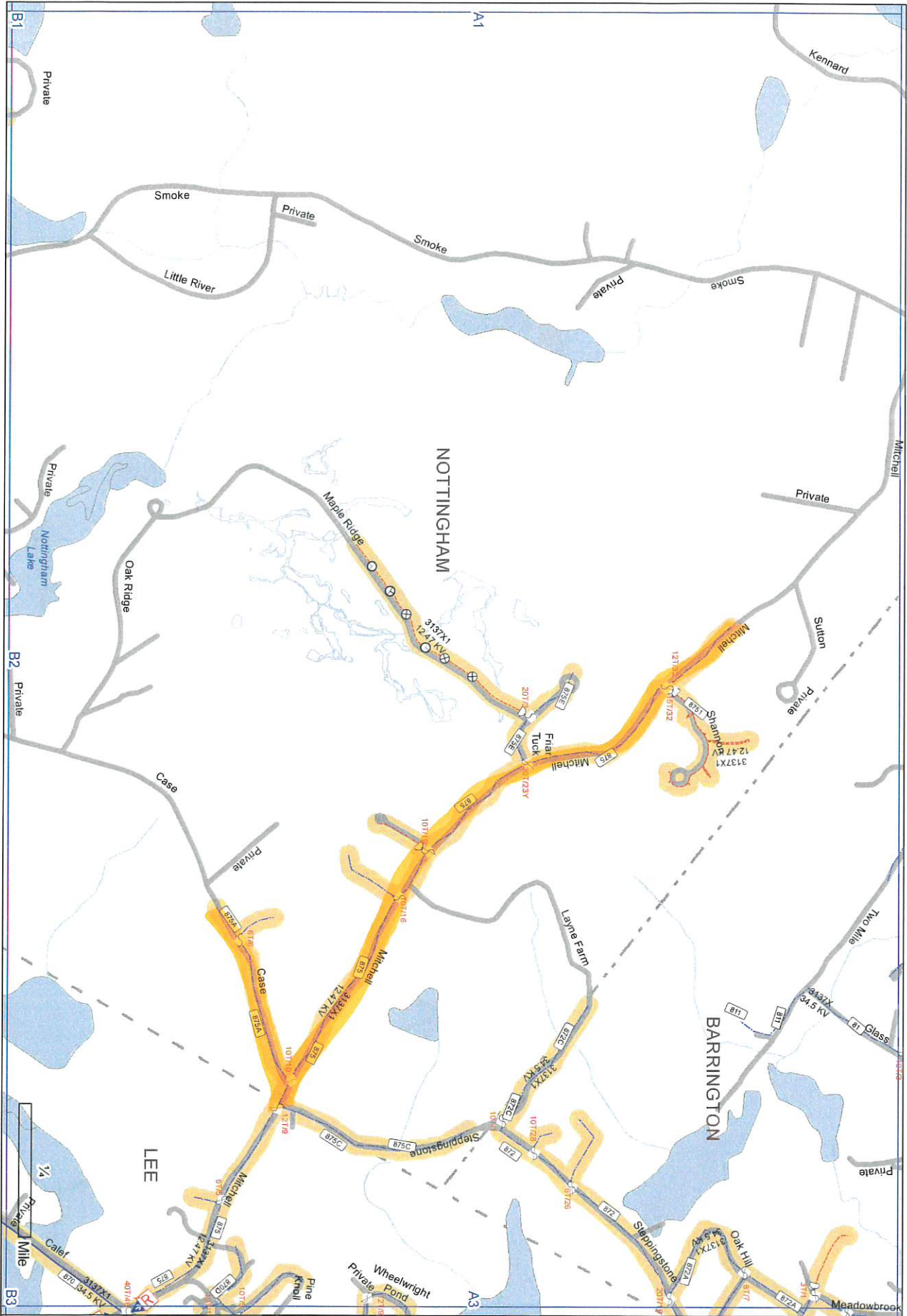

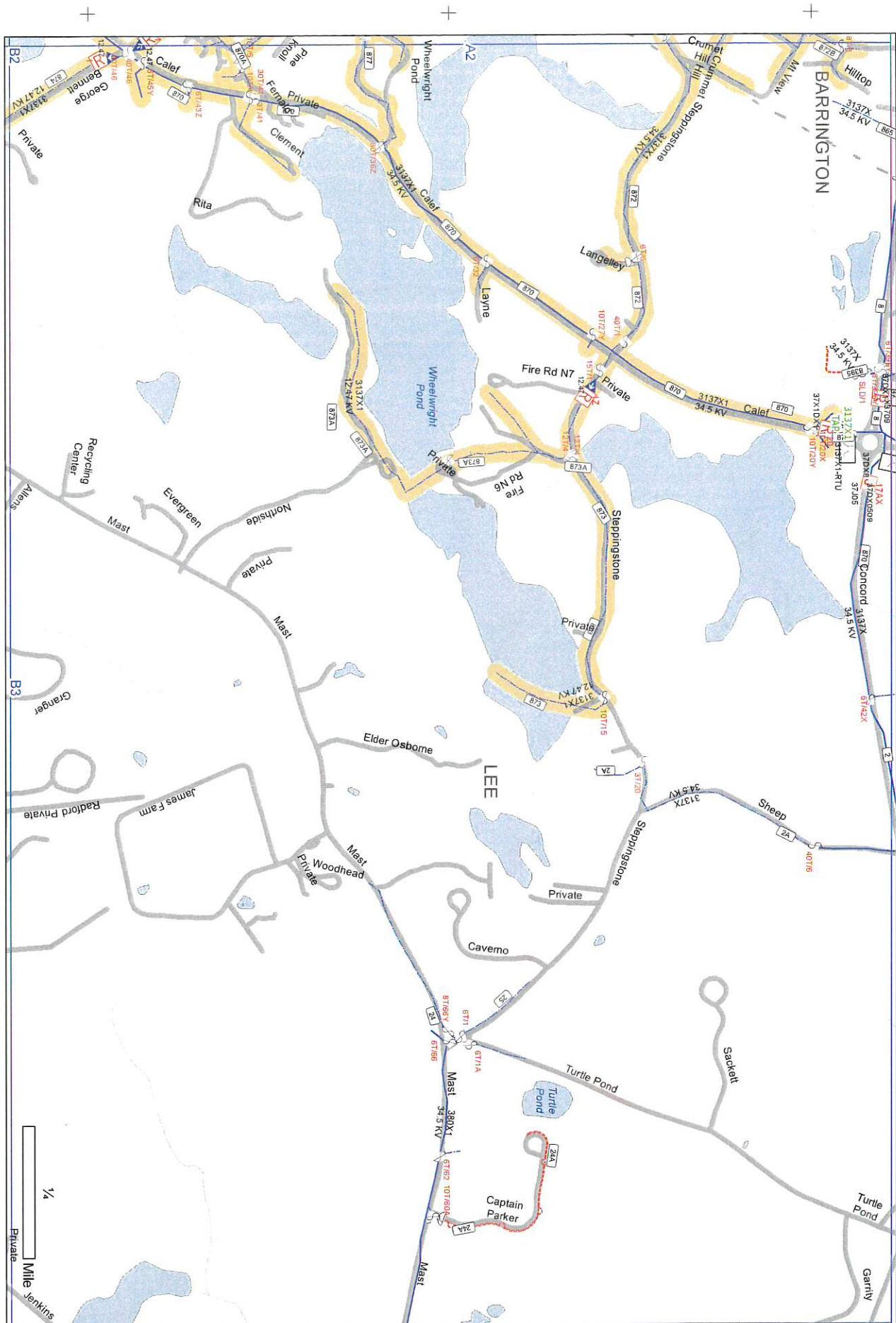

Eversource

- Fire
- Nursing Home
- Police
- Hospital

3137X1

S/S: 3137X1 TAP

Date: 1/3/2020

Feedback: Ronald.Rioux@eversource.com

CEII

Total Customers: 1,686

Grid: A3

Page 4 of 10



A3

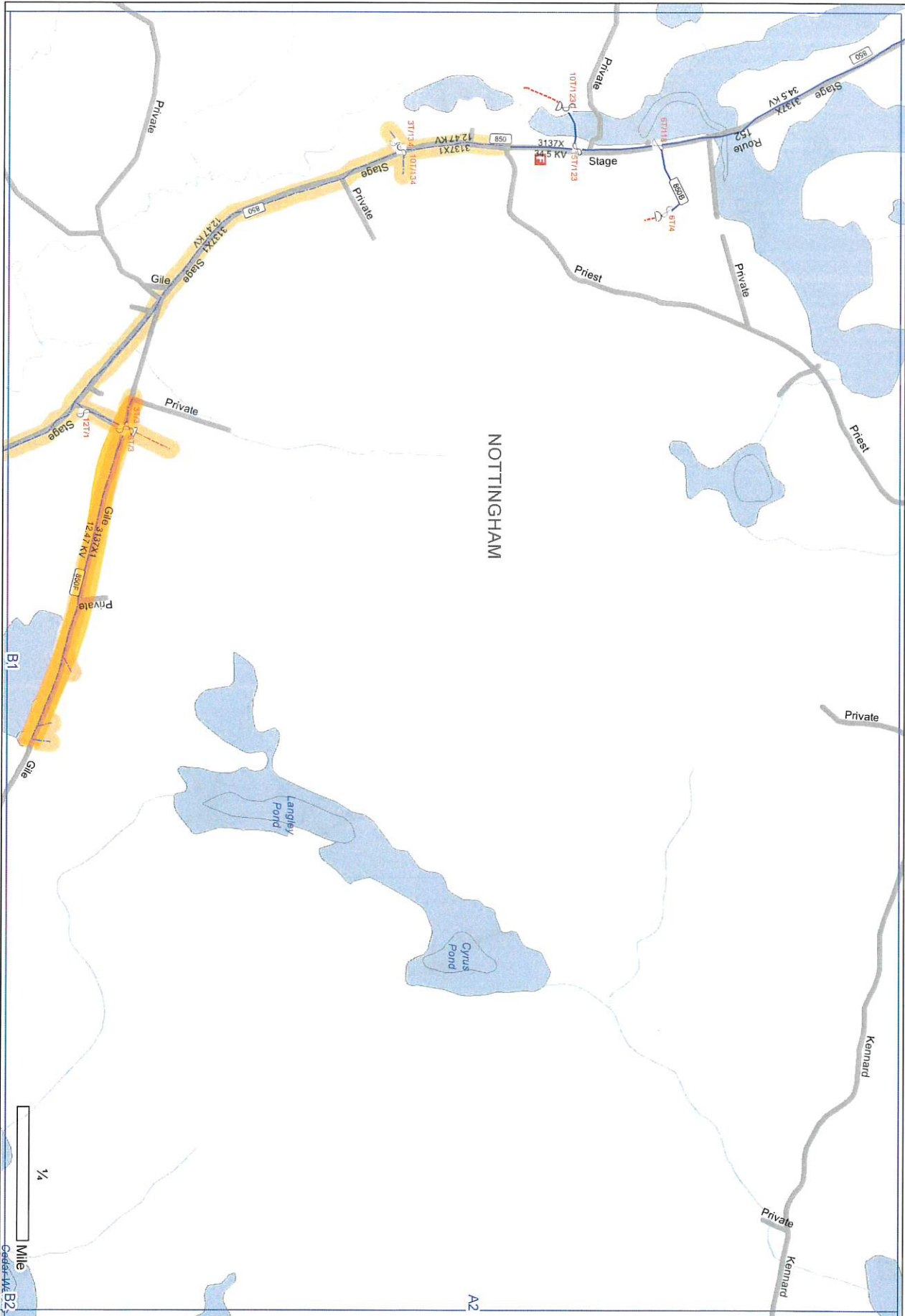

Eversource

- F Fire
- N Nursing Home
- P Police
- H Hospital

3137X1

S/S: 3137X1 TAP

Date: 1/3/2020

Feedback: Ronald.Rioux@eversource.com

CEII

Total Customers: 1,686

Grid: A1

Page 2 of 10



A1

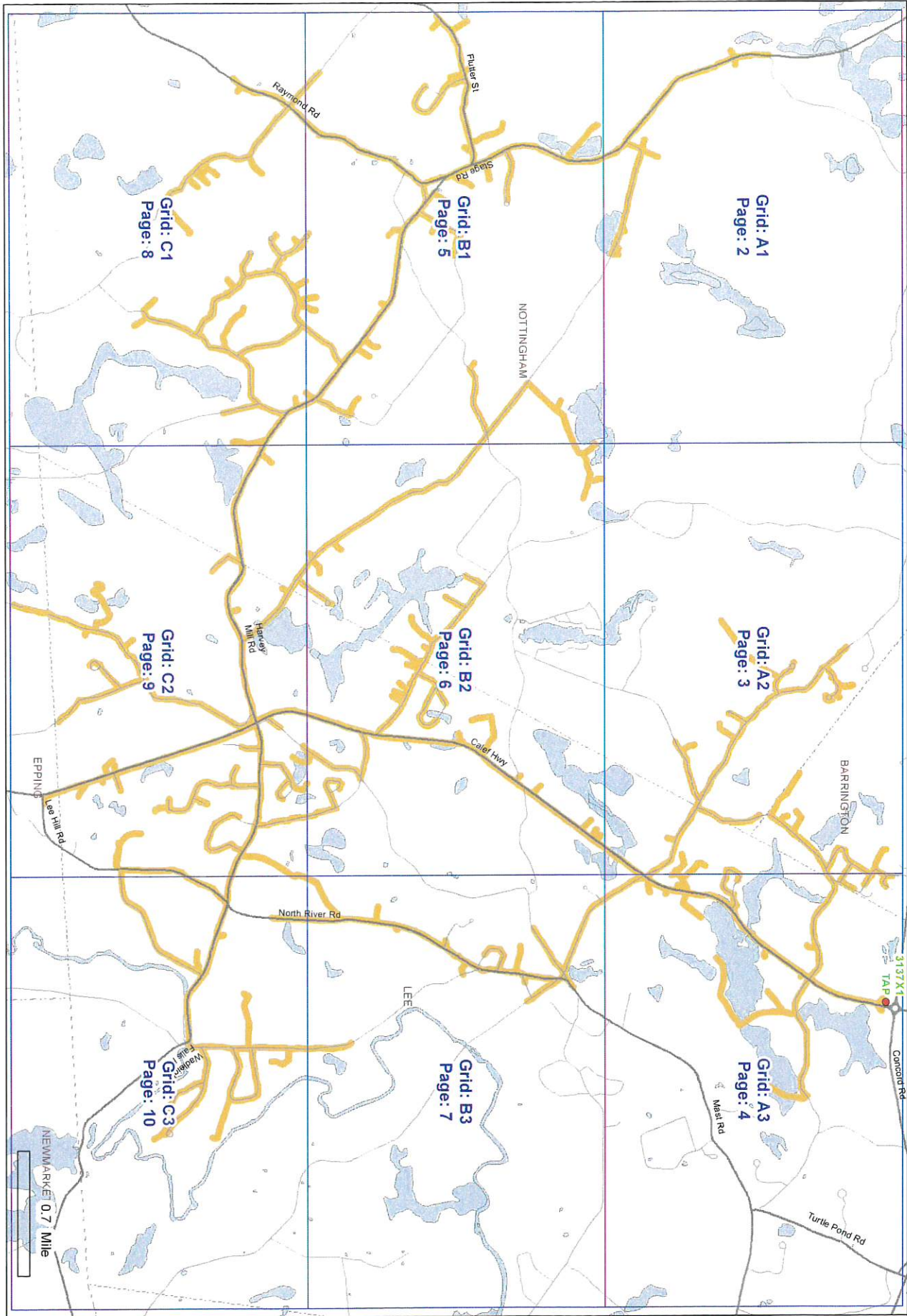

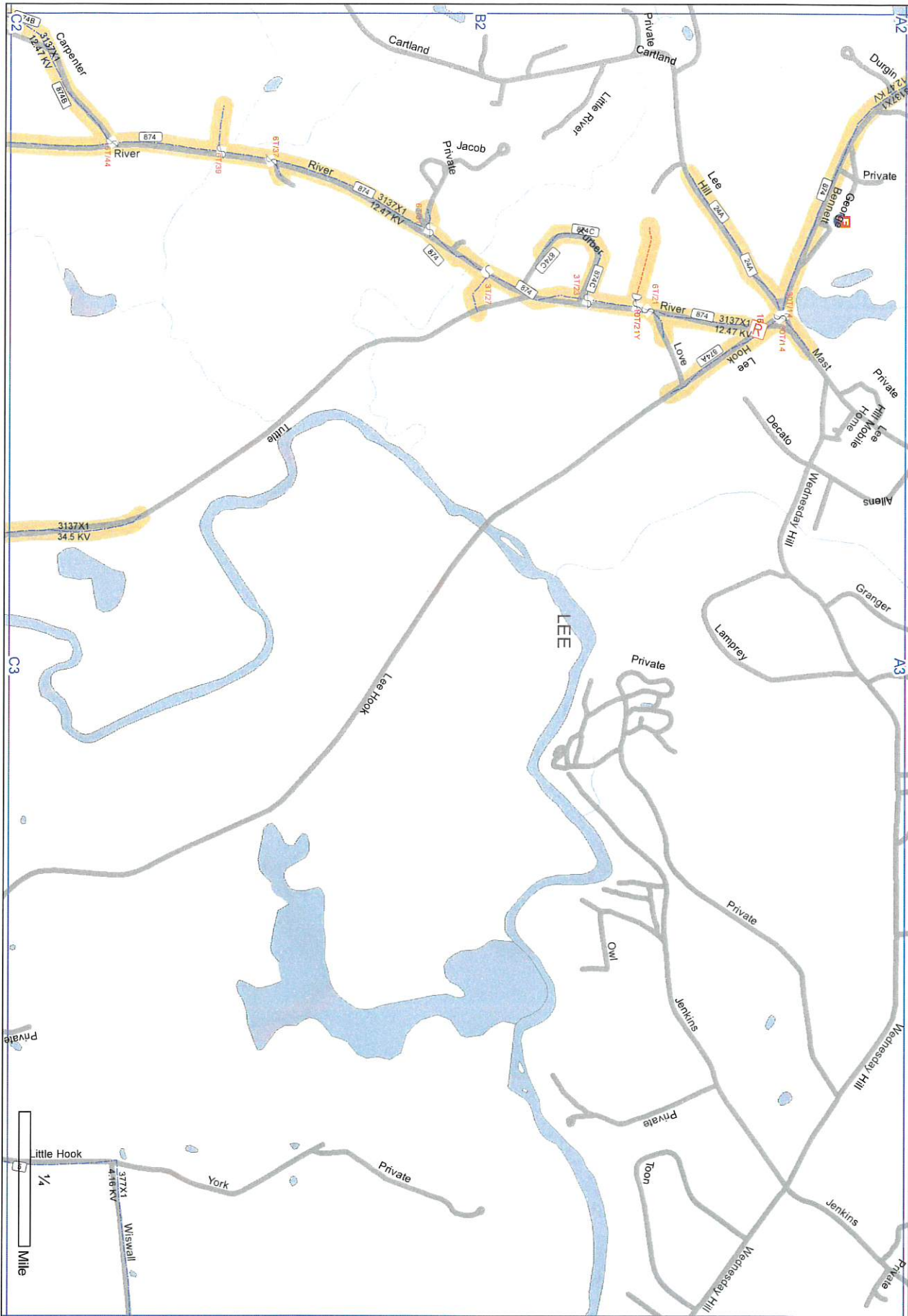

Eversource

- F Fire
- N Nursing Home
- P Police
- H Hospital

3137X1

S/S: 3137X1 TAP

Date: 1/3/2020

Feedback: Ronald.Rioux@eversource.com

CEI

Total Customers: 1,686

Grid: B3

Page 7 of 10



B3

NOTTINGHAM - LEDGE FARM, POOR FARM

