

ZONING REQUIREMENTS

ZONE: RESIDENTIAL/AGRICULTURAL-(RA)
 MIN. LOT SIZE = 2 ACRES
 MIN. FRONTAGE = 200'
 MAX. HEIGHT = 34'
 MIN. OPEN SPACE = 60%

BUILDING SETBACKS:
 FRONT 50'
 SIDE & REAR 50'
 POORLY DRAINED SOILS 50'
 VERY POORLY DRAINED SOILS 75'

LEACH FIELD SETBACKS:
 POORLY DRAINED SOILS 75'
 VERY POORLY DRAINED SOILS 75'

PREPARED FOR:
JOSEPH FALZONE
 7B EMERY LANE
 STRATHAM, N.H. 03885



70 PORTSMOUTH AVE,
 THIRD FLOOR, SUITE 2
 STRATHAM, N.H. 03885
 PHONE: 603-583-4860,
 FAX: 603-583-4863

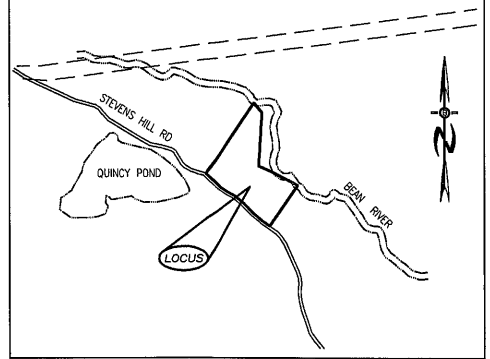

LOCATION MAP
 1"=2000'

TAX MAP 43, LOT 3
 LONG OAK REALTY TRUST
 ROBERT L. SUBERTO
 NOTTINGHAM, NH 03290

TAX MAP 29, LOT 8
 FERNALD LUMBER INC.
 NOTTINGHAM, NH 03290

TAX MAP 29, LOT 8
 FERNALD LUMBER INC.
 NOTTINGHAM, NH 03290

TAX MAP 45, LOT 8-1
 ROBERT DANIEL
 NOTTINGHAM, NH 03290
 R.C.R.D. BOOK 5977, PAGE 1530

TAX MAP 47, LOT 3
 LONG OAK REALTY TRUST
 ROBERT L. SUBERTO
 NOTTINGHAM, NH 03290

LOT 4
 206272 SF
 4.74 Ac.
 BUILDABLE
 32927 SF

LOT 8
 272546 SF
 6.28 Ac.
 BUILDABLE
 45920 SF

LOT 6
 210270 SF
 4.83 Ac.
 BUILDABLE
 40534 SF

LOT 5
 162772 SF
 3.74 Ac.
 BUILDABLE
 45546 SF

LOT 7
 188776 SF
 4.33 Ac.
 BUILDABLE
 49582 SF

LOT 1
 355047 SF
 8.15 Ac.
 BUILDABLE
 31510 SF

LOT 2
 33400 SF
 7.57 Ac.
 BUILDABLE
 35999 SF

LOT 3
 232546 SF
 5.34 Ac.
 BUILDABLE
 31916 SF

TAX MAP 45, LOT 8
 JOSHUA F. STEVENS
 NOTTINGHAM, NH 03290
 R.C.R.D. BOOK 3772, PAGE 151

TAX MAP 45, LOT 4-11
 VICTORIA C. COMBES
 NOTTINGHAM, NH 03290
 R.C.R.D. BOOK 4926, PAGE 867

TAX MAP 45, LOT 4-10
 SHARONNA SCHEPPE M. REVOCABLE TRUST
 NOTTINGHAM, NH 03290
 R.C.R.D. BOOK 6229, PAGE 1247

TAX MAP 45, LOT 4-9
 JEFFREY M. SILVA
 NOTTINGHAM, NH 03290
 R.C.R.D. BOOK 5732, PAGE 1155

TAX MAP 45, LOT 4-5
 SHARONNA SCHEPPE M. REVOCABLE TRUST
 NOTTINGHAM, NH 03290
 R.C.R.D. BOOK 5656, PAGE 847

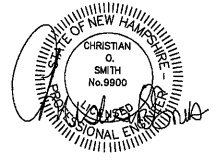

REVISIONS:	DATE:

SUBDIVISION SITE PLAN

FOR:
 RESIDENTIAL DEVELOPMENT
 STEVENS HILL RD
 NOTTINGHAM, NH

DATE:	JUNE 2022	SCALE:	1"=100'
PROJ. NO.:	NH-1435	SHEET NO.:	8 OF 9