

NOTES:

- 1) THIS PLAN DOES NOT SHOW ANY UNRECORDED OR UNWRITTEN EASEMENTS WHICH MAY EXIST. A REASONABLE AND DILIGENT ATTEMPT HAS BEEN MADE TO OBSERVE ANY APPARENT VISIBLE USES OF THE LAND. HOWEVER, THIS DOES NOT CONSTITUTE A GUARANTEE THAT NO SUCH EASEMENTS EXIST.
- 2) THIS PARCEL DOES PARTIALLY LIE WITHIN THE FLOOD ZONE, SEE F.I.R.M. COMMUNITY PANELS 33015C 0115E AND 33015C 0120E, DATE MAY 17, 2005.
- 3) ALL ELEVATIONS ARE BASED ON N.A.V.D. 1988.
- 4) THE NEAREST FIRE CISTERN IS LOCATED ON SHANNON DRIVE OFF OF MITCHELL ROAD, APPROXIMATELY 2 MILES AWAY.

RECORD OWNERS

CONCRETE PRODUCTS OF LONDONDERRY
SHEA CONCRETE PRODUCTS
87 HAVERHILL STREET
AMESBURY, MA 01913
BK. 3426 PG. 2205

LOT AREA
1,539,975 S.F.±
35.4 ACRES±

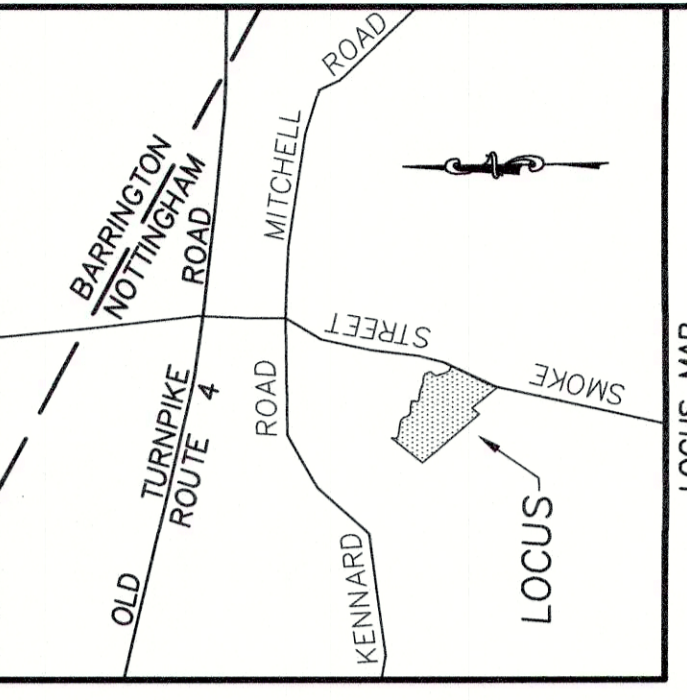

PURSUANT TO RSA 676:18 III AND RSA 672:14

I CERTIFY THAT THIS SURVEY PLAT IS NOT A SUBDIVISION PURSUANT TO THIS TITLE AND THAT THE LINES OF STREETS AND WAYS SHOWN ARE THOSE OF PUBLIC OR PRIVATE STREETS OR WAYS ALREADY ESTABLISHED AND THAT NO NEW WAYS ARE SHOWN.

I CERTIFY:
THAT THIS ACTUAL SURVEY WAS MADE ON THE GROUND BETWEEN MARCH 2020 AND JUNE 2023.
THAT THIS SURVEY CONFORMS TO THE REQUIREMENTS FOR ACCURACY FOR N.H. URBAN SURVEY.

6
N/F
MICHAEL G. & FAY A. LITTLEFIELD
110 SMOKE STREET
NOTTINGHAM, NH 03290
BK. 4791 PG. 2922

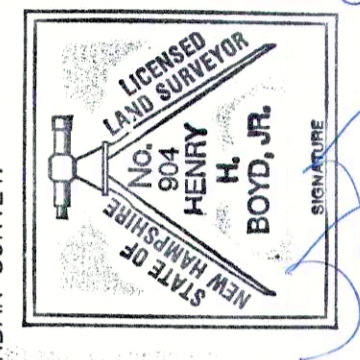

LICENSED LAND SURVEYOR DATE 6-20-2023

ZONING DISTRICT R/A

MINIMUM REQUIREMENTS

AREA 2 ACRES
FRONTAGE 200 FEET
FRONT SETBACK 50 FEET
SIDE SETBACK 50 FEET
REAR SETBACK 50 FEET

** LOT FALLS WITHIN AQUIFER PROTECTION DISTRICT WHICH REQUIRES 3 AC. MINIMUM LOT SIZE **



11
5
N/F
RAYMOND S. KENNARD, JR. & LISA KENNARD
119 KENNARD ROAD
NOTTINGHAM, NH 03290
BK. 2834 PG. 2005

WETLANDS DELINEATION BY:
WEST ENVIRONMENTAL
48 STEVENS HILL ROAD
NOTTINGHAM, NH 03290

IN ACCORDANCE WITH THE 1987 CORPS OF ENGINEERS WETLANDS DELINEATION MANUAL, AS REQUIRED BY THE DES WETLANDS BUREAU.



LEGEND

- S.B. STONE BOUND
- I.P. IRON PIPE
- I. ROD IRON ROD
- FND. FOUND
- ASSESSORS MAP AND PARCEL
- UTILITY POLE
- W1 WETLAND FLAG
- W2 VERY POORLY DRAINED SOILS
- VPD VPD

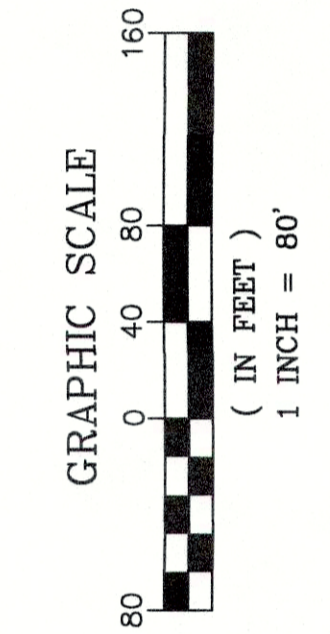

7
9
N/F
DAVID B. FERNALD
JOHN T. FERNALD JR. TRUSTEE
57 RAYMOND ROAD
NOTTINGHAM, NH 03290
BK. 5913 PG. 639

7
9
F.B.M. MAGNETIC NAIL SET
ELEV = 176.54 (NAVD 1986)

10
4-3
N/F
STEPHEN J. & MEGAN E. MILLER
87 SMOKE STREET
NOTTINGHAM, NH 03290
BK. 6092 PG. 771

11
1-1
N/F
KEVIN NORR
90 SMOKE STREET
NOTTINGHAM, NH 03290
BK. 4439 PG. 2359

11
4
N/F
EMILIO & NINA JIMENEZ
106 SMOKE STREET
NOTTINGHAM, NH 03290
BK. 6270 PG. 860

NOTTINGHAM PLANNING BOARD APPROVAL

EXISTING CONDITIONS	
PLAT OF LAND	
IN	
NOTTINGHAM, NH	
SHOWING	
A PROPOSED SUBDIVISION	
AT 100 SMOKE STREET	
(ASSESSORS MAP 11 LOT 3)	
RECORD OWNERS	
CONCRETE PRODUCTS OF LONDONDERRY	
87 HAVERHILL ROAD, AMESBURY, MA 01913	
MILLENNIUM ENGINEERING INC.	
ENGINEERS AND LAND SURVEYORS	
P.O. BOX 745 13 HAMPTON ROAD EXETER, NH 03833	
PHONE:(603)778-0528 FAX:(603)772-0689 WWW.MEI-NH.COM	
SCALE: 1"=80'	PROJECT: M203707
DATE: FEB. 13, 2023	CHKD. BY: H.H.B. SHEET: 3 OF 4

NO.	DATE	DESCRIPTION	BY
3	09-18-23	ADD NOTICE OF DECISION	P.D.B.
2	04-05-23	ADD SHORELAND SETBACKS	H.H.B.